

União Fêmea reta rosca BSP paralela

Somente Corpo

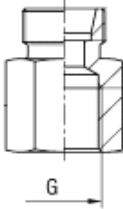

Com porca e anilha

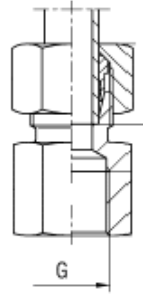

Série	Bar	Código Novo	Tubo	Rosca Tubo	G	Código Novo
LEVE	315	UFA 06X1/8 BSP-L	6	12x1.5	1/8"-28	XX3317731X-06-02
		UFA 06X1/2 BSP-L	6	12x1.5	1/2"-14	XX3317731X-06-08
		UFA 08X1/4 BSP-L	8	14x1.5	1/4"-19	XX3317731X-08-04
		UFA 08X3/8 BSP-L	8	14x1.5	3/8"-19	XX3317731X-08-06
		UFA 10X1/4 BSP-L	10	16x1.5	1/4"-19	XX3317731X-10-04
		UFA 10X3/8 BSP-L	10	16x1.5	3/8"-19	XX3317731X-10-06
		UFA 12X3/8 BSP-L	12	18x1.5	3/8"-19	XX3317731X-12-06
		UFA 15X1/2 BSP-L	15	22x1.5	1/2"-14	XX3317731X-15-08
	UFA 18X1/2 BSP-L	18	26x1.5	1/2"-14	XX3317731X-18-08	
	160	UFA 22X3/4 BSP-L	22	30x2.0	3/4"-14	XX3317731X-22-12
		UFA 28X1 BSP-L	28	36x2.0	1"-11	XX3317731X-28-16
		UFA 35X1.1/4 BSP-L	35	45x2.0	1.1/4"-11	XX3317731X-35-20
UFA 42X1.1/2 BSP-L		42	52x2.0	1.1/2"-11	XX3317731X-42-24	
PESADA	630	UFA 06X1/4 BSP-S	6	14x1.5	1/4"-19	XX3318731X-06-04
		UFA 08X1/4 BSP-S	8	16x1.5	1/4"-19	XX3318731X-08-04
		UFA 10X3/8 BSP-S	10	18x1.5	3/8"-19	XX3318731X-10-06
		UFA 12X3/8 BSP-S	12	20x1.5	3/8"-19	XX3318731X-12-06
		UFA 14X1/2 BSP-S	14	22x1.5	1/2"-14	XX3318731X-14-08
	400	UFA 16X1/2 BSP-S	16	24x1.5	1/2"-14	XX3318731X-16-08
		UFA 20X3/4 BSP-S	20	30x2.0	3/4"-14	XX3318731X-20-12
		UFA 25X3/4 BSP-S	25	36x2.0	3/4"-11	XX3318731X-25-12
		UFA 25X1 BSP-S	25	36x2.0	1"-11	XX3318731X-25-16
		UFA 30X1.1/4 BSP-S	30	42x2.0	1.1/4"-11	XX3318731X-30-20
315	UFA 38X1.1/2 BSP-S	38	52x2.0	1.1/2"-11	XX3318731X-38-24	

União Fêmea reta rosca Métrica paralela

Somente Corpo

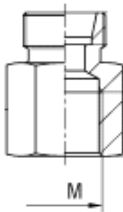

Com Porca e Anilha

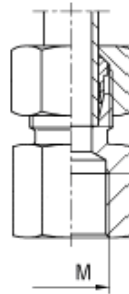

Série	Bar	Código Antigo	Tubo	M	Código Novo	
LEVE	315	UFA 06XM10X1.0-L	6	10x1.0	XX3317761X-06-10	
		UFA 08XM12X1.5-L	8	12x1.5	XX3317761X-08-12	
		UFA 10XM14X1.5-L	10	14x1.5	XX3317761X-10-14	
		UFA 12XM16X1.5-L	12	16x1.5	XX3317761X-12-16	
		UFA 15XM18X1.5-L	15	18x1.5	XX3317761X-15-18	
	160	UFA 18XM22X1.5-L	18	22x1.5	XX3317761X-18-22	
		UFA 22XM26X1.5-L	22	26x1.5	XX3317761X-22-26	
		UFA 28XM33X2.0-L	28	33x2.0	XX3317761X-28-33	
		UFA 35XM42X2.0-L	35	42x2.0	XX3317761X-35-42	
		UFA 42XM48X2.0-L	42	48x2.0	XX3317761X-42-48	
PESADA	630	UFA 06XM12X1.5-S	6	12x1.5	XX3318761X-06-12	
		UFA 08XM14X1.5-S	8	14x1.5	XX3318761X-08-14	
		UFA 10XM16X1.5-S	10	16x1.5	XX3318761X-10-16	
		UFA 12XM18X1.5-S	12	18x1.5	XX3318761X-12-18	
		UFA 14XM20X1.5-S	14	20x1.5	XX3318761X-14-20	
	400	UFA 16XM22X1.5-S	16	22x1.5	XX3318761X-16-22	
		UFA 20XM27X2.0-S	20	27x2.0	XX3318761X-20-27	
		UFA 25XM33X2.0-S	25	33x2.0	XX3318761X-25-33	
		UFA 30XM42X2.0-S	30	42x2.0	XX3318761X-30-42	
	315		UFA 38XM48X2.0-S	38	48x2.0	XX3318761X-38-48

União Fêmea reta rosca NPT cônica

Somente Corpo

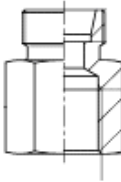

P

Com porca e anilha

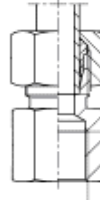

P

Série	Bar	Código Antigo	Tubo	Rosca Tubo	P	Código Novo
LEVE	315	UFA 06X1/8 NPT-L	6	12x1.5	1/8"-27	XX3317581X-06-02
		UFA 06X1/4 NPT-L	6	12x1.5	1/4"-18	XX3317581X-06-04
		UFA 06X3/8 NPT-L	6	12x1.5	3/8"-18	XX3317581X-06-06
		UFA 08X1/4 NPT-L	8	14x1.5	1/4"-18	XX3317581X-08-04
		UFA 10X1/4 NPT-L	10	16x1.5	1/4"-18	XX3317581X-10-04
		UFA 12X3/8 NPT-L	12	18x1.5	3/8"-18	XX3317581X-12-06
	160	UFA 15X1/5 NPT-L	15	22x1.5	1/2"-14	XX3317581X-15-08
		UFA 18X1/2 NPT-L	18	26x1.5	1/2"-14	XX3317581X-18-08
		UFA 22X3/4 NPT-L	22	30x2.0	3/4"-14	XX3317581X-22-12
		UFA 28X1 NPT-L	28	36x2.0	1"-11.1/2	XX3317581X-28-16
PESADA	630	UFA 35X1.1/4 NPT-L	35	45x2.0	1.1/4"-11.1/2	XX3317581X-35-20
		UFA 42X1.1/2 NPT-L	42	52x2.0	1.1/2"-11.1/2	XX3317581X-42-24
		UFA 06X1/4 NPT-S	6	14x1.5	1/4"-18	XX3318581X-06-04
		UFA 08X1/4 NPT-S	8	16x1.5	1/4"-18	XX3318581X-08-04
		UFA 10X3/8 NPT-S	10	18x1.5	3/8"-18	XX3318581X-10-06
		UFA 12X1/4 NPT-S	12	20x1.5	1/4"-18	XX3318581X-12-04
	400	UFA 12X3/8 NPT-S	12	20x1.5	3/8"-18	XX3318581X-12-06
		UFA 12X1/2 NPT-S	12	20x1.5	1/2"-18	XX3318581X-12-08
		UFA 14X1/2 NPT-S	14	22x1.5	1/2"-14	XX3318581X-14-08
		UFA 16X1/2 NPT-S	16	24x1.5	1/2"-14	XX3318581X-16-08
		UFA 20X3/4 NPT-S	30	42x2.0	3/4"-14	XX3318581X-20-12
		UFA 25X3/4 NPT-S	25	36x2.0	3/4"-14	XX3318581X-25-12
		UFA 25X1 NPT-S	25	36x2.0	1"-11.1/2	XX3318581X-25-16
		UFA 30X1.1/4 NPT-S	30	42x2.0	1.1/4"-11.1/2	XX3318581X-30-20
315	UFA 38X1.1/2 NPT-S	38	52x2.0	1.1/2"-11.1/2	XX3318581X-38-24	

União Fêmea para Manômetro rosca BSP (Paralela) (Manômetro não incluso)

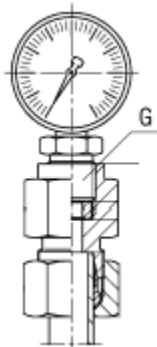

Série	Bar	Código Novo	Tubo	Rosca Tubo	G	Código Novo
L	315	UFMA 08X1/4 BSP-L	6	12x1.5	1/4"-19	XX3317751X-06-04
		UFMA 08X1/4 BSP-L	8	14x1.5	1/4"-19	XX3317751X-08-04
		UFMA 10X1/4 BSP-L	10	16x1.5	1/4"-19	XX3317751X-10-04
		UFMA 12X1/4 BSP-L	12	18x1.5	1/4"-19	XX3317751X-12-04
S	630	UFMA 06X1/2 BSP-S	6	14x1.5	1/2"-14	XX3318751X-06-08
		UFMA 08X1/2 BSP-S	8	16x1.5	1/2"-14	XX3318751X-08-08
		UFMA 10X1/2 BSP-S	10	18x1.5	1/2"-14	XX3318751X-10-08
		UFMA 12X1/2 BSP-S	12	20x1.5	1/2"-14	XX3318751X-12-08