

## União Igual

Somente Corpo

Com porca e anilha

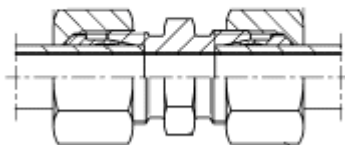

Série	Bar	Código Antigo	Tubo	Rosca Tubo	Código Novo
Super Leve	100	UDA 04-LL	4	8x1.0	XX3316161X-04-04
		UDA 06-LL	6	10x1.0	XX3316161X-06-06
		UDA 08-LL	8	12x1.0	XX3316161X-08-08
LEVE	315	UDA 06-L	6	12x1.5	XX3317171X-06-06
		UDA 08-L	8	14x1.5	XX3317171X-08-08
		UDA 10-L	10	16x1.5	XX3317171X-10-10
		UDA 12-L	12	18x1.5	XX3317171X-12-12
		UDA 15-L	15	22x1.5	XX3317171X-15-15
		UDA 18-L	18	26x1.5	XX3317171X-18-18
	160	UDA 22-L	22	30x2.0	XX3317171X-22-22
		UDA 25-L	25	34x2.0	XX3317171X-25-25
		UDA 28-L	28	36x2.0	XX3317171X-28-28
		UDA 35-L	35	45x2.0	XX3317171X-35-35
		UDA 38-L	38	48x2.0	XX3317171X-38-38
		UDA 42-L	42	52x2.0	XX3317171X-42-42
PESADA	630	UDA 06-S	6	14x1.5	XX3318181X-06-06
		UDA 08-S	8	16x1.5	XX3318181X-08-08
		UDA 10-S	10	18x1.5	XX3318181X-10-10
		UDA 12-S	12	20x1.5	XX3318181X-12-12
		UDA 14-S	14	22x1.5	XX3318181X-14-14
	400	UDA 16-S	16	24x1.5	XX3318181X-16-16
		UDA 20-S	20	30x2.0	XX3318181X-20-20
		UDA 25-S	25	36x2.0	XX3318181X-25-25
		UDA 30-S	30	42x2.0	XX3318181X-30-30
		UDA 38-S	38	52x2.0	XX3318181X-38-38
315	UDA 38-S	38	52x2.0	XX3318181X-38-38	

## União Igual reta Painel

Somente Corpo

Com porca e anilha

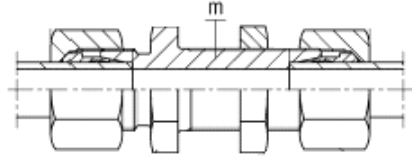
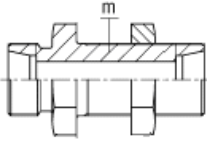

Série	Bar	Código Antigo	Tubo	Rosca Tubo	Código Novo
LEVE	315	UCA 06-L	6	12x1.5	XX3417171X-06-06
		UCA 08-L	8	14x1.5	XX3417171X-08-08
		UCA 10-L	10	16x1.5	XX3417171X-10-10
		UCA 12-L	12	18x1.5	XX3417171X-12-12
		UCA 15-L	15	22x1.5	XX3417171X-15-15
		UCA 18-L	18	26x1.5	XX3417171X-18-18
	160	UCA 22-L	22	30x2.0	XX3417171X-22-22
		UCA 28-L	28	36x2.0	XX3417171X-28-28
		UCA 35-L	35	45x2.0	XX3417171X-35-35
PESADA	630	UCA 06-S	6	14x1.5	XX3418181X-06-06
		UCA 08-S	8	16x1.5	XX3418181X-08-08
		UCA 10-S	10	18x1.5	XX3418181X-10-10
		UCA 12-S	12	20x1.5	XX3418181X-12-12
		UCA 14-S	14	22x1.5	XX3418181X-14-14
	400	UCA 16-S	16	24x1.5	XX3418181X-16-16
		UCA 20-S	20	30x2.0	XX3418181X-20-20
		UCA 25-S	25	36x2.0	XX3418181X-25-25
		UCA 30-S	30	42x2.0	XX3418181X-30-30
	315	UCA 38-S	38	52x2.0	XX3418181X-38-38